



Vancouver Film Studios



Building A consists of two sound stages: Stage A1 is 12,500 sq. ft. and Stage A2 is 15,000 sq. ft.  
All buildings on the Vancouver Film Studios lot are equipped with 24-hour security.



STAGE A1

|             |   |
|-------------|---|
| SQUARE FEET | 12,500  |
| DIMENSIONS  | 100' x 125'   |
| HEIGHT      | 40'   |
| SOUND       | Building acoustically designed with tilt up concrete walls<br>Acoustical insulation on walls and ceiling<br>16' x 16' sound door  |
| POWER       | 3200 amps 120/208v<br>40 watts per sq. ft.<br>3 phase power services from two locations, each with four 400 amp camlocks<br>Director control plugs throughout stage                     |
| AIR         | Heating and fresh air exchange<br>Mechanical atmospheric smoke exhaust<br>Ceiling fans  |
| STRUCTURE   | Wooden catwalk system<br>Truss system for rigging and lights<br>Truss load of 40 lbs/squ. ft. (average), max point load of 3,500 lbs. per truss<br>Clearspan<br>16' x 16' overhead door |

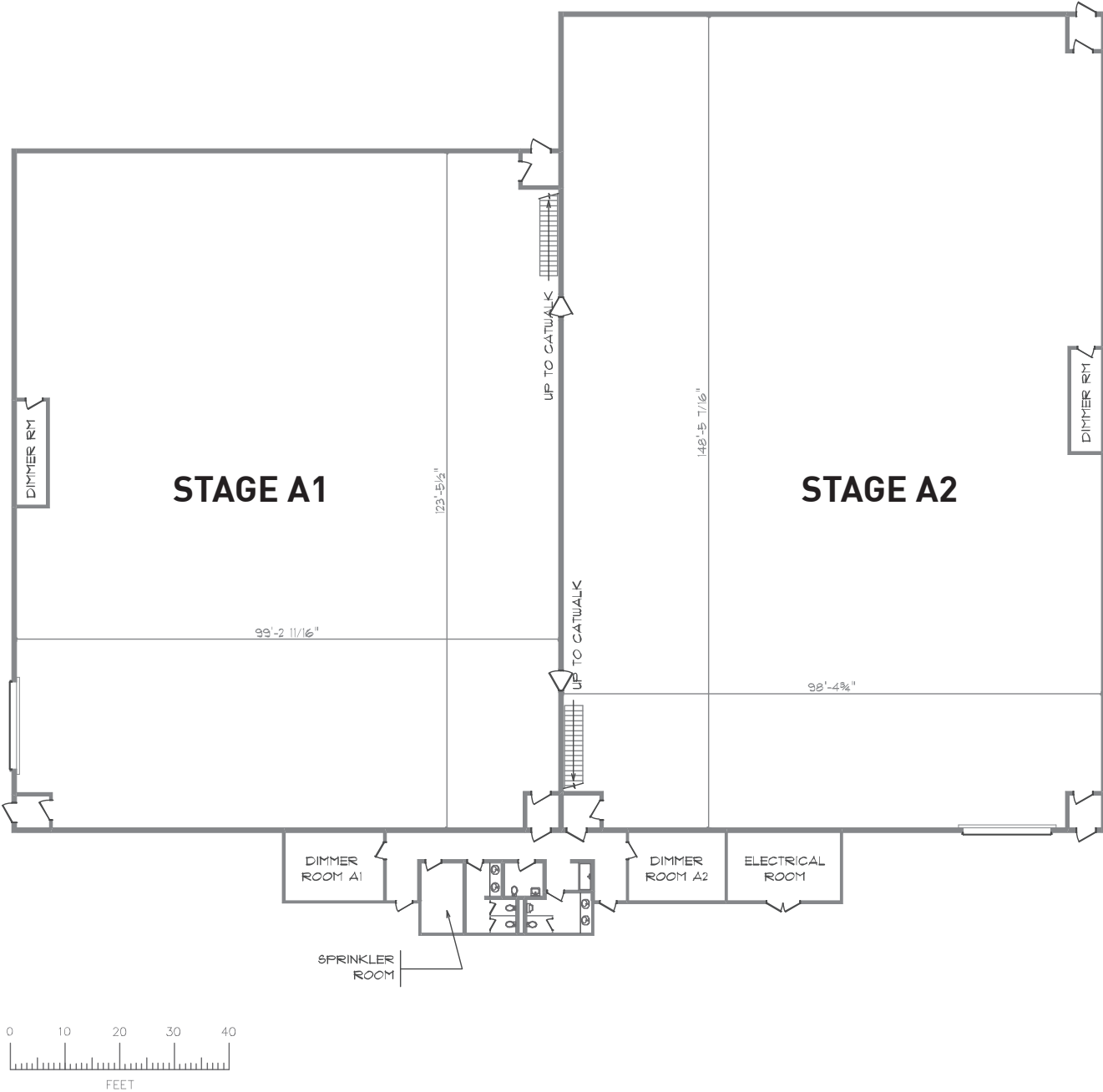



Vancouver Film Studios



Building A consists of two sound stages: Stage A1 is 12,500 sq. ft. and Stage A2 is 15,000 sq. ft.  
All buildings on the Vancouver Film Studios lot are equipped with 24-hour security.



STAGE A2

|             |   |
|-------------|---|
| SQUARE FEET | 15,000  |
| DIMENSIONS  | 100' x 150'   |
| HEIGHT      | 40'   |
| SOUND       | Building acoustically designed with tilt up concrete walls<br>Acoustical insulation on walls and ceiling<br>16' x 16' sound door  |
| POWER       | 3200 amps 120/208v<br>40 watts per sq. ft.<br>3 phase power services from two locations, each with four 400 amp camlocks<br>Director control plugs throughout stage                     |
| AIR         | Heating and fresh air exchange<br>Mechanical atmospheric smoke exhaust<br>Ceiling fans  |
| STRUCTURE   | Wooden catwalk system<br>Truss system for rigging and lights<br>Truss load of 40 lbs/squ. ft. (average), max point load of 3,500 lbs. per truss<br>Clearspan<br>16' x 16' overhead door |

