

BUILDING A

Building A consists of two sound stages: Stage A-1 is 12,500 sq. ft. and Stage A-2 is 15,000 sq. ft., opened in April of 2002.

All buildings on the Vancouver Film Studios lot are equipped with 24-hour security.

Stage A-1

SQUARE FEET	12,500
DIMENSIONS	100' x 125'
HEIGHT	40'
SOUND	Acoustical insulation 16' x 16' sound door Building acoustically designed with tilt up concrete walls
POWER	Directors control panels, four points 40 watts per sq. ft. 3 phase power services from two locations, each with four camlocks
AIR	Mechanical smoke exhaust fans Fresh air exchange heating
STRUCTURE	Cleats Protective roll up doors Wooden catwalk system Truss system for lights Truss load of 40 lbs/sq. ft. (average), max point load of 3,500 lbs. per truss Clearspan

Stage A-2

SQUARE FEET	15,000
DIMENSIONS	100' x 150'
HEIGHT	40'
SOUND	Acoustical insulation 16' x 16' sound door Building acoustically designed with tilt up concrete walls
POWER	Directors control panels, four points 40 watts per sq. ft. 3 phase power services from two locations, each with four camlocks
AIR	Mechanical smoke exhaust fans Fresh air exchange heating
STRUCTURE	Cleats Protective roll up doors Wooden catwalk system Truss system for lights Truss load of 40 lbs/sq. ft. (average), max point load of 3,500 lbs. per truss Clearspan

BUILDING A

USEABLE AREA
29026 SQUARE FEET

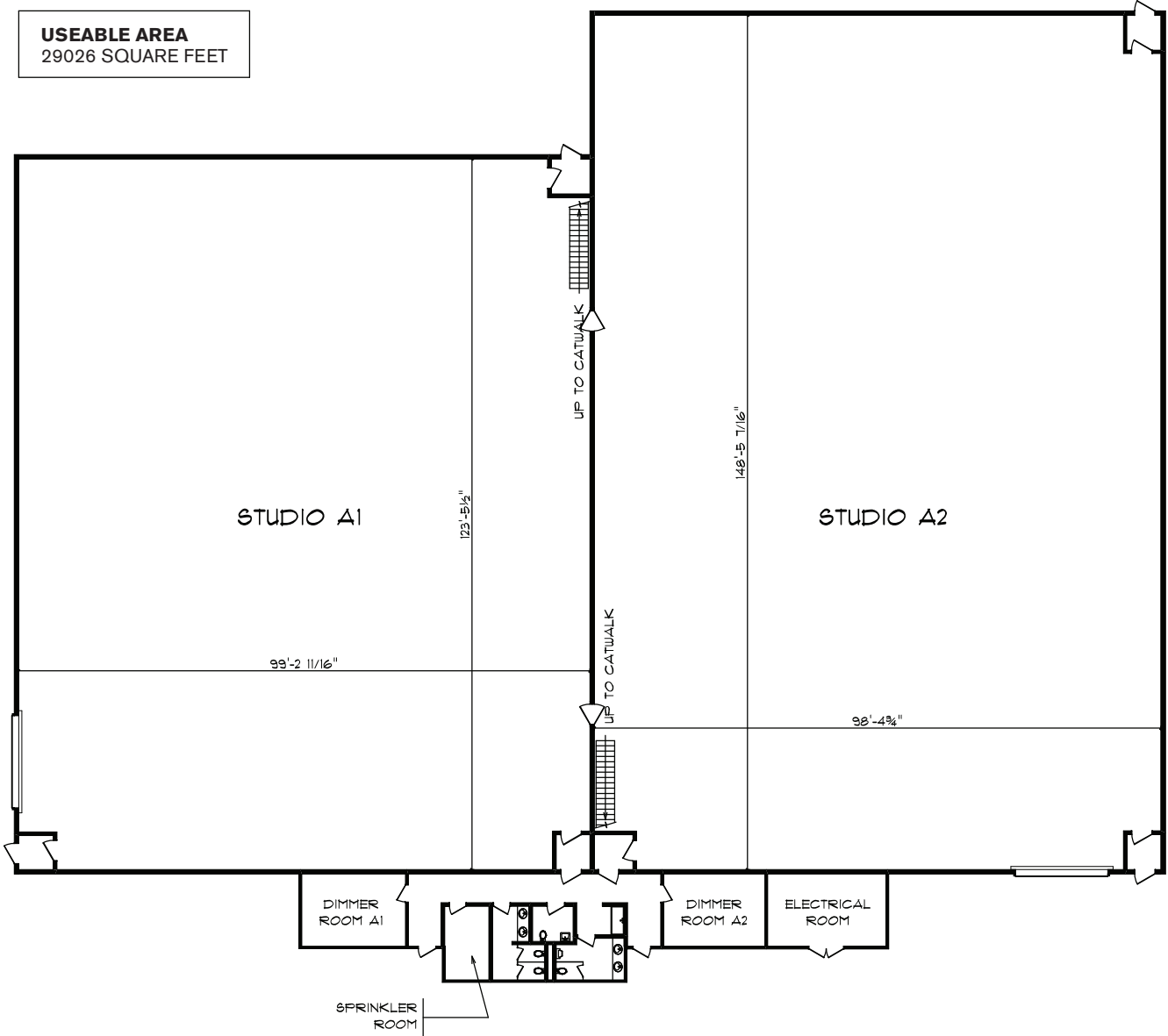

<p>Vancouver Film Studios Building A 3525 Cornett Road Vancouver, BC</p>	<p>Drawn By:</p>	<p>Gerry Parsons BOMA CERTIFIED TECHNICIAN</p>	<p>0 10 20 30 FEET</p>	<p>Accuspace Measuring www.accuspacemeasuring.com</p>
	<p>December 18, 2007</p>			